

versatile

DP-8020E



Digital Imaging Systems

High Speed; Up to 20 ppm
Digital Printing / Copying

Versatile Scanner with Internet Fax

Standard Document Handling Software

Security Features

Panasonic ideas for life

8020

all-around printing



> Compact affordable workgroup solutions

Combining printer and copier functions in a single platform with ledger-size capability, the DP-8020E provides a practical, cost effective solution for office document processing. The standard 10/100 Ethernet interface allows the DP-8020E to serve as a network printer right out of the box. By moving the output tray "inside" and eliminating protruding paper trays, the DP-8020E's small footprint saves valuable office space. This compact "wingless" design enables installation anywhere, even on a small desktop.

> High Speed Network Ready Printing

When connected to your office LAN via the standard 10Base-T/100Base-TX Ethernet interface, the DP-8020E serves as a high-speed, high-quality laser printer capable of handling documents up to ledger (11 x 17") size. Even while performing at a quick 20 ppm (letter size), the printer maintains crisp 1,200 dpi equivalent x 600 dpi*³ image quality. This standard connectivity will allow all the PCs on your LAN to take advantage of the printing capabilities and cost savings provided by the WORKIO DP-8020E. When connecting to an individual PC, a standard USB interface is available. To top it all off, the DP-8020E has a variety of business friendly functions such as Duplex Mode, Poster Mode, and N-in-1 Print.

*³ - Optional Printer Controller Module or Multi Page Description Language Controller Module is required.

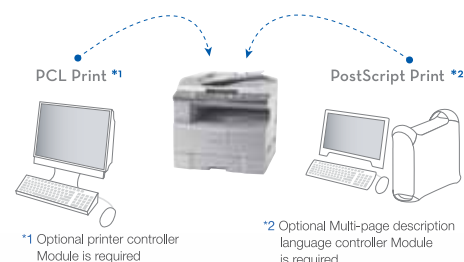

> You Know it's Ready

The Device Monitor allows you to check the current status of the DP-8020E without leaving your desk. When the toner is low or the paper tray is empty, users can respond immediately especially when trying to meet an important deadline.



> Duplex Versatility

Duplex capability is standard on the DP-8020E, enabling printing, copying and faxing on both sides of the paper for higher productivity and economical savings. Used in combination with one of the optional Automatic Document Feeders (ADF), the user can stack single-sided originals in the document feeder and reduce paper consumption by creating two-sided copies.

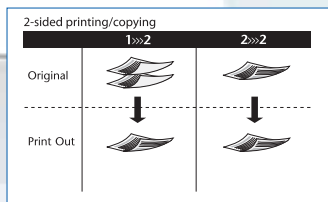

versatile copying

2-in-1 Copying

This handy feature saves paper by fitting two reduced images on one sheet.

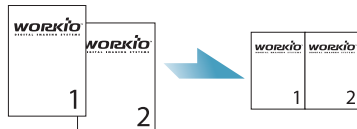

Completion Notice

The **Completion Notice** Function will automatically notify you when your copy job is complete, thus avoiding any costly downtime.

Digital SkyShot

By making a copy with the cover open, this convenient function eliminates annoy-ing black borders that also waste toner.



> High Speed Digital Copier

The DP-8020E copies at a quick 20 ppm with crisp 600 dpi quality, provides ledger-size input and output, and improves efficiency with Double Exposure, 2-in-1 Copying, Digital SkyShot and Image Rotation. An Automatic Document Feeder (ADF) and an inverting Automatic Document Feeder (iADF) are available as options to accelerate copying of multi-page originals. And with standard electronic sorting, you won't have to hand-sort those larger copy jobs. In addition to 600 x 600 dpi resolution and a 256 level gray scale, the DP-8020E consistently provides optimum image quality by constantly monitoring and adjusting for room temperature and humidity conditions.

Double Exposure

By selecting the Double Exposure function, users can make quality copies of double-sided documents on a single sheet of paper without the black borders, even if the platen cover is open. This is especially convenient for copying small double-sided originals such as ID and insurance cards, checks, and receipts.

With Double Exposure



First Pass Image 1

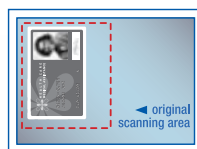

Second Pass Image 2



> Optional keyboard

The optional keyboard allows registration of up to 32 stations for Fax numbers, Email addresses and PC addresses for easy, one-touch sending. In addition, you can use the QWERTY keyboard to name your documents before you scan or email them.

> Scanning – the first step toward versatile imaging communication

The DP-8020E is also a powerful network scanner that revolutionizes document distribution. The standard Network Scanner function quickly converts paper documents up to ledger size into high-resolution 600 dpi digital files for easy storage and distribution. Plus the "File-Naming" feature gives you the freedom to name the file before you scan for easy identification.

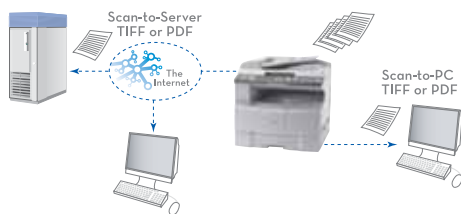

> New document management & collaboration tool

Our Quick Image Navigator software features a Windows-like document structure which assists you with previewing PDF thumbnails, adding annotations and edits, and sends image files to various destinations with one easy application on your desktop.



quick faxing

> High Speed Super G3 Fax



With the optional Super G3 Fax, the WORKiO DP-8020E is a powerful fax station capable of high-resolution transmission and reception of up to Ledger-size documents with 0.7 sec.*³ high-speed "Quick Scanning" and Quick Memory Transmission. The DP-8020E is capable of faxing up to 50 sheets at one time and with the **Fax Job Build** function, even documents of more than 50 sheets that were scanned at different times can be sent at once. The optional fax communication board and standard **Panafax Desktop software** allows users to fax documents directly from their PC via the LAN and WORKiO to fax machines around the world.

*3 - Letter portrait in Standard or Fine mode with ADF

> Know Your Users

-User Authentication-

User Authentication not only bolsters security and ease of administration by using the same user names and passwords registered in your Windows Active Directory server database, but it also enables the setting of usage restrictions on printing and copying for more efficient cost management and control.

-Mailbox-

The Mailbox feature gives users the chance to store print jobs at the device. This way, users are able to print documentation at a later time to help keep their print job separate from everyone else's.

-Secure Mailbox-

Confidential documents can be temporarily stored in the secure mailbox. Users enter their password to safely print out the documents at any time they choose.

> Keep track of work

The optional Network Accounting Software collects and tabulates log information data such as number of prints, copies, scans and faxes. Office administrators can obtain an analysis by both department and user to gain valuable insight on the current usage of the device such as the number of prints, copies, scans, and faxes. The **Job Tracking** function confirms the volume of faxes, PC Faxes, and email transmissions / receptions.



Compact High Speed Multifunctional Solution

Welcome to the world of WORKiO® digital imaging platforms where digital communications and imaging technology converge. Empowering your business with more versatility, higher reliability, greater ease of use and expanded network connectivity, Panasonic's WORKiO is the "office power tool" for your business, and the DP-8020E is no exception.

High-speed Network Printing

- Network ready
- N-in-1, Poster mode, Overlay function
- Print status
- Duplex printing

Powerful Copying

- Compact wingless 20 cpm digital copier
- Fast first copy of 6.9 sec
- Digital skyshot, Double exposure, Completion notice
- Duplex copying

Network Scanning

- Standard 0.7 sec. per page Network scanner (Scan to PC)
- Scan to Email
- Easy document management operation (Quick Image Navigator)

High-speed Super G3 Fax (Option)

- Fast 2.7 sec. transmission
- Quick memory Transmission
- Fax Job Build
- Optional Keyboard

Enhanced Security

- Network User Authentication
- Job Tracking with Network Accounting Manager (Option)
- Mailbox/Secure Mailbox Printing
- Department Code by function (Print/Copy/Scan/Fax)



DP-8020E Options

Hard Disk

Hard Drive Unit
DA-HD18
(Optional Image Memory is required)

Flash Memory
4MB Flash Memory / 8MB Flash Memory
UE-410047F / UE-410048F

Software

Accounting System

Accounting Software
DA-WA10

Other Options

Keyboard Option
DA-KB180

Key Counter Harness Kit
DA-KH180

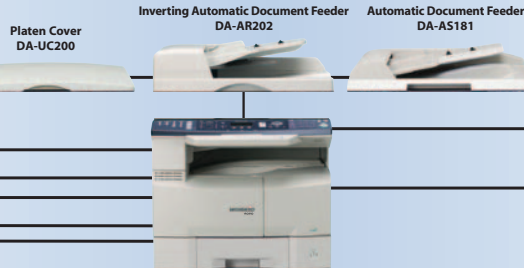

Fax Option

G3 Fax
Fax Communication Board
DA-FG180

Printer / Network Printer Options

Printer Controller Module
DA-PC820

Multi Page Description Language Controller Module
DA-MC820

Expansion F-ROM Board

DA-EM600F

Full-Height Configurations

Paper Feed Options

For Wheelchair Configurations

1-Paper Tray Configuration

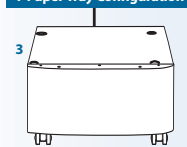

2-Paper Tray Configuration



3-Paper Tray Configuration

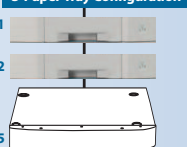

4-Paper Tray Configuration



- 1- 2nd/4th Paper Feed Module
DA-DS184
- 2- 3rd Paper Feed Module
DA-DS185
- 3- 1-Drawer Configuration Stand
DA1D18A
- 4- 2-Drawer Configuration Stand
DA1D18B
- 5- 3&4-Drawer Configuration Stand
DA1D18C

1-Paper Tray Configuration

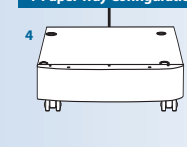

2-Paper Tray Configuration

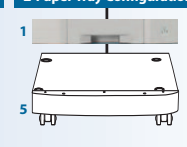

DP-8020E Specifications

General

Type	Desktop
Copy / Print Process	Laser Indirect Electrostatic
Developing Process	Dry Dual Component
Automatic Document Feeder (Option)	50 sheets (Letter, 20 lb, 75 g/m ²)
Inverting Automatic Document Feeder (Option)	50 sheets (Letter, 20 lb, 75 g/m ²)
Paper Feed	550-sheet paper tray x 1 + 50-sheet bypass Max. 2,250 sheets with option
Paper Weight	Paper Tray: 16 to 24 lb (60 to 90 g/m ²) Bypass: 15 to 34 lb (55 to 133 g/m ²)
Automatic Duplex Unit	Standard
Power Requirements	AC 120, 60 Hz, 12A
Power Consumption	Max.: Less than 1.3 kW Power save mode: Approx. 19W Sleep mode: Approx. 8.5 W
Warm-up Time (68°F/20°C)	Approx. 30 sec. (Main power switch ON) Approx. 30 sec. (Sleep mode)
Dimensions (W x D x H)*1 (H = Height To Platen Glass)	22.0" x 21.9" x 18.1" (558 x 557 x 460 mm) (Excluding optional equipment)
Weight*1	Approx. 95.5 lb (43.3 kg) (Excluding optional equipment)

Printer

Network Printer Interface	Ethernet 10Base-T/100Base-TX
Communication Protocol	TCP/IP, LPD (LPR), IPP*, AppleTalk (PS), SNMP, DHCP
Local Printer Interface	USB
Printer Language (Standard) (Option)	Panasonic Printing System for Windows® PCL 5e Emulation, PCL 6 Emulation Adobe® PostScript®3™
Printing Speed*2 (from 1st paper tray)	20 ppm
Paper Size	Paper Tray: Ledger-Invoice Bypass: Ledger-Envelope (#10) 1,200 dpi equivalent x 600 dpi (PCL, PS) 600 dpi x 600 dpi, 300 dpi x 300 dpi (GDI, PCL, PS)
Printing Resolution	1,200 dpi equivalent x 600 dpi (PCL, PS) 600 dpi x 600 dpi, 300 dpi x 300 dpi (GDI, PCL, PS)
Printer Memory	20 MB
PCL/PS Spool Memory	6 GB with optional 40 GB HDD
Compatible Client Operating Systems	Windows® XP/2000/Server 2003, 98, Me, Windows NT® 4.0 MacOS 8.6-10.4*3
Compatible Network Operating Systems	Windows NT 4.0, Windows 2000/Server 2003, Unix (LPR)*4, Linux (LPR)*4

Digital Copier

Resolution	600 x 600 dpi
Gray Scale	256 steps
First Copy Time	Approx. 6.9 sec.
Multi Copy Speed*2	20 cpm (from 1st Paper Tray)
Maximum Original Size	Ledger
Copy Size	Ledger-Invoice
Copy Ratio	Enlargement (fixed) 200 %, 155 %, 129 %, 121 % Reduction (fixed) 79 %, 77 %, 65 %, 61 %, 50 %
Zoom (variable)	50-200 % (in 1 % increments)
Multiple Copy	1 to 999, Automatic reset to 1
Exposure Control	Text, Text/Photo, Photo
Sort Memory (Standard) (Option)	16 MB Base Memory plus 16 MB / 64 MB / 128 MB 12 GB (with optional 40 GB HDD)

Network Scanner

Network Scanner Interface	Ethernet 10Base-T/100Base-TX
Maximum Scanning Size	Ledger
Scanning Resolution	150 dpi x 150 dpi, 300 dpi x 300 dpi, 600 dpi x 600 dpi
Scanning Speed*5	Approx. 1.1 sec. (Letter portrait in 150 dpi x 150 dpi, 300 dpi x 300 dpi from ADF)
Coding Scheme	JBIG / MMR / MR / MH
Data Format	TIFF, PDF

G3 Fax (Option)

Compatibility	ITU-T Group 3, ECM
Modem Speed	33.6 kbps
Coding Scheme	JBIG / MMR / MR / MH
Scanning Speed*5	Approx. 0.7 sec. (Letter portrait in Standard or Fi ne mode)
Transmission Speed*6	Approx. 2.7 sec.
Scanning Resolution	Standard: 203 dpi x 98 lpi (8 dots/mm x 3.85 lines/mm) Fine: 203 dpi x 196 lpi (8 dots/mm x 7.7 lines/mm) Super Fine: 406 dpi x 391 lpi (16 dots/mm x 15.4 lines/mm) 600 dpi: 600 dpi x 600 dpi
Effective Scanning Width	Ledger (11 1/2")
Recording Resolution	600 x 600 dpi
Standard Memory*7	2 MB (approx. 120 pages)
Optional Memory*7	Base memory plus 4 MB (320 pages)/8 MB (640 pages)
Speed Dials	1032 (abbreviation + optional keyboard + optional HDD)

Internet Fax/Scan to Email*8

Compatibility	IETF RFC 3965, ITU-T T.37
Communication Protocol	TCP/IP, SMTP, POP3, MIME, LDAP, DNS
Network Connectivity	Ethernet 10Base-T/100Base-TX (IEEE 802.3)
Data Format	TIFF (Profile S/F/J), PDF*9

Dimensions



Notes

- *1 Dimensions and weight are approximate.
- *2 Speeds are contingent upon applications, machine configuration, and status. Individual speeds may vary.
- *3 Multi Page Description Language Controller Module option required.
- *4 Printer Controller Module or Multi Page Description Language Controller Module option required.
- *5 Scanning speed applies to the feeding process from the top to the end of a single page test chart. The time for the feeding process does not include the time that it takes for the top edge of the page to reach the scanning point and page ejection. Time for entire storing process is not applied.
- *6 Transmission time applies to memory transmission of text data using only ITU-T Image No.1 between the same models at maximum modem speed. Transmission time may vary in actual usage. Usually public telephone lines can only support communication speeds of 28.8 Kbps or lower. Via PBX, transmission speed may fall back to a lower speed.
- *7 Based on ITU-T Image No.1 scanned in Standard mode.
- *8 Depending on the receiving machines capability, the document may not be correctly printed depending on the chosen resolution and document size.
- *9 T.37 Internet Fax only supports TIFF format.

Design and specifications are subject to change without notice.

Microsoft® Windows® NT® and Windows Server® are registered trademarks of Microsoft Corporation. Adobe, PostScript and PostScript 3 are either registered trademarks or trademarks of Adobe Systems Incorporated in the United States and/or other countries. PCL is a registered trademark of Hewlett-Packard. WORKKO® is a registered trademark of Matsushita Electric Industrial Co., Ltd. All other brand or product name are the property of their respective holders.

This Product is designed to reduce hazardous chemical substances along with the RoHS directive

Panasonic®

Panasonic Digital Document Company
Unit of Panasonic Corporation of North America

One Panasonic Way, Secaucus, NJ 07094
For a local dealer, please call 1-800-742-8086
panasonic.com/office



As an Energy Star® Partner, Panasonic has determined that this product meets the Energy Star® Guidelines for energy efficiency.

